

QUICK COUPLER BROCHURE





THE ENHANCED CLAW

The new industry standard for Quick Couplers

Geith International is very proud to present to you our Enhanced CLAW Quick Couplers.

In 2001 Geith successfully brought the “CLAW” Coupler to the market. Since then we have sold over 50.000 couplers from Dublin to Dubai and beyond. So far it has exceeded our customer’s expectations due to it’s unique advantages. Now, almost a decade later Geith proudly presents an enhancement of our CLAW Quick Coupler. This new coupler is built to withstand all latest developments in the market and more. With these enhancements; this coupler is safer than any product in the market and will result in decreased cost of ownership due to excellent engineering and manufacturing skills.

Decrease in total cost of ownership due to:

Less down time due to easy maintenance and parts protection system

Longer life due to increased strength and materials

10% Increased machine performance due to a more compact design

Increased in Safety due to:

Multiple Locking

Anti Swing Mechanism

Front Pin Positive locking

Meets and exceeds all industry safety criteria

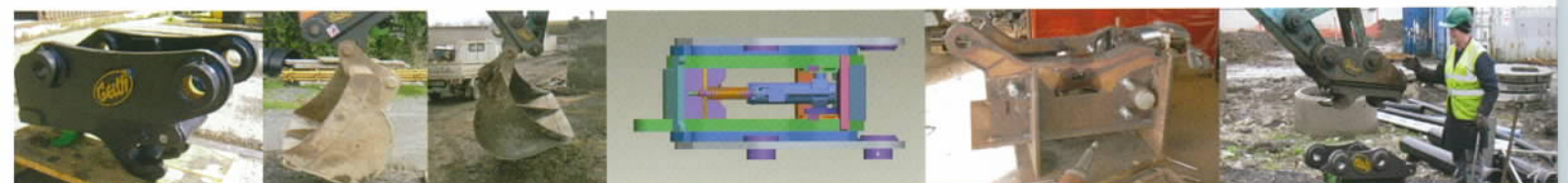

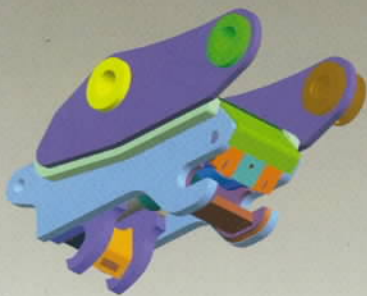

OUR MODELS

GEITH QUICK COUPLERS			
MODEL	PIN DIAMETER (MM)	MODEL	PIN DIAMETER (MM)
QH40H	40	QC65H	65
QC45H	45	QH70H	70
QC50H	50	QC80H	80
QH55H	55	QH90H	90
QH60H	60	QH100H	100

Manual and larger Quick couplers available on request



Buckets, Rippers, Angle Tilts, Couplers or any other attachment, customers of Geith can always rely on the years of experience in designing, manufacturing and selling world class products. Since our well-known coupler already has many good features, we don't have to come out with a new coupler. We just have build on the existing proven base model. Which include:

- Visible Front Lock System
- Reliable and fully tested check-valve
- Fully automatic quick coupler
- OEM Set up (made to fit your exact machine)
- Mix Match capability (Any kind of bucket on any kind of machine)

Geith International recognises the importance of the quality all our products. In order to make sure we only deliver a product that meets our high quality standards to our customers we have a special focus on this topic. Our engineers have several decades of experience in designing high quality products. We also have a dedicated quality and warranty department that is willing to help out on the rare occasion something does go wrong. We also make sure all of our Quick Couplers meet and exceed major industry standards such as "the machinery directive" and "the EN474".

